



A.B.C. BROTHERS

INDUSTRIAL & PROJECTS SAFETY SOLUTIONS

Your Lockout/ Tag out Expert

What is Lockout/ Tagout?

According to OSHA standards for control of hazardous energy (lockout / tagout), Title 29 CFR Part 1910.147, addresses the practices and procedures necessary to disable machinery or equipment, preventing the release of hazardous energy while employees perform servicing and maintenance activities

The standard outlines measures for controlling hazardous energies such as electrical, mechanical, hydraulic, pneumatic, chemical, thermal and other energy sources.

In addition to this, CFR 1910.333 sets forth requirements to protect employees working on electrical circuits and equipments. This section requires workers to use safe work practices, including lockout and tagging procedures.

These provisions apply when employees are exposed to electrical hazards while working on , near or with conductors or systems that use electricity.



A.B.C. BROTHERS

INDUSTRIAL & PROJECTS SAFETY SOLUTIONS





SAFETY LOCKOUT HASP

Manufactured from steel with a red insulated body. Scissor action with 25mm/38mm diameter jaw size. Accepts padlocks with a shackle diameter up to 10mm.

Place the Lockout Hasp through the isolating point and lock the Hasp by placing a Lockout Padlock in any one of the six holes provided for locking. This will ensure that the Lockout Hasp cannot be opened unless the padlock is removed. Upton 6 padlocks can be used for group locking..

Safety Lockout Hasp with 25mm jaw.



LM-H-25

Safety Lockout Hasp with 38mm jaw.



LM-H-38



SAFETY LOCKOUT HASP

De-Electric Lockout Hasps are used where metal cannot be used. It is made of tough plastic and has 6 padlock holes where padlock up to 8mm shackle diameter can be used for group locking.

Instruction for Use:

Place the Lockout Hasp through the isolating point and lock the Hasp by placing a Lockout Padlock in any one of the six holes provided for locking. This will ensure that the Lockout Hasp cannot be opened unless the padlock is removed. Up to 6 padlocks can be used for group locking.



De-Electric Hasp

LM-DH-6

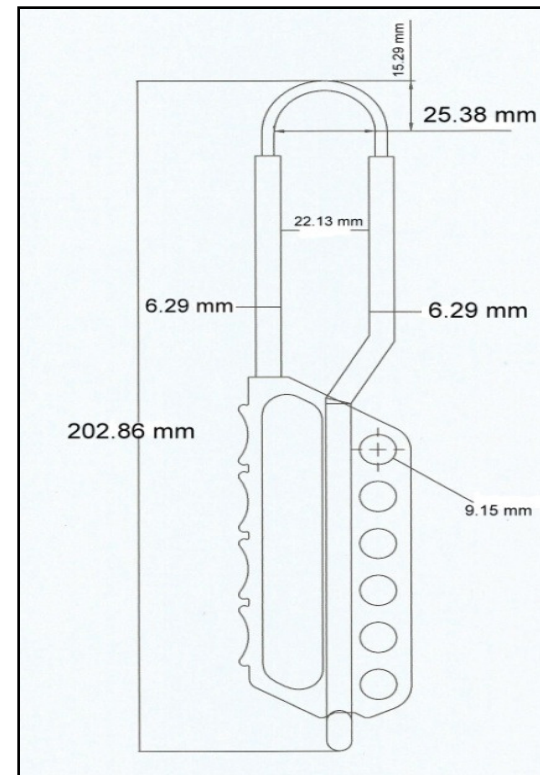



SAFETY LOCKOUT PADLOCKS

Lotomaster De-Electric safety Lockout padlocks come with a plastic shackle which helps prevent electrocution and arc flashing. These padlocks have standard shackle length of 40mm and 6-pin precision machined keys for extra security. They are available in 8 bright colours and also key different, key alike and with master key option to best suit your Lockout/Tagout program.

Instruction for Use:

To lock the padlock, just insert the shackle into the lock hole and turn the key. The Padlock has key retaining feature wherein the key cannot be removed if the shackle is in open position. This feature ensures that the padlock is not left unlocked without its key.

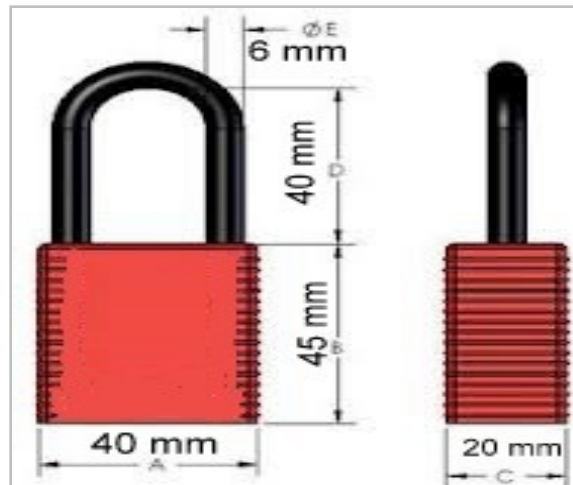

De-Electric Padlock

LM-DEPL



SAFETY LOCKOUT PADLOCKS

Lotomasters safety padlocks are compact yet rugged with tough, durable and ultra lightweight lock body which make it ideal for use in harsh industrial environments. These padlocks are available in 8 different colors with different shackle lengths. Also available in key different, key alike and with master key option to best suit your Lockout/ Tagout program.

Instruction for Use:

To lock the padlock, just insert the shackle into the lock hole and turn the key. The Padlock has key retaining feature wherein the key cannot be removed if the shackle is in open position. This feature ensures that the padlock is not left unlocked without its key.

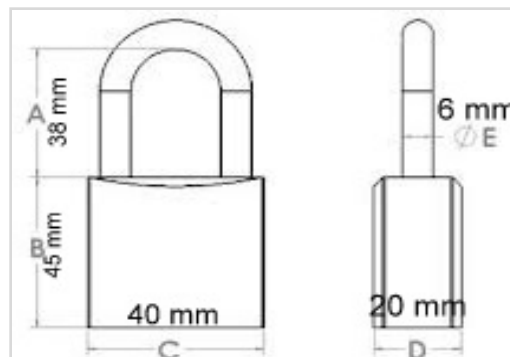

**Ultra Lightweight
Padlock with 40mm
shackle**

LM-ULPP-RS

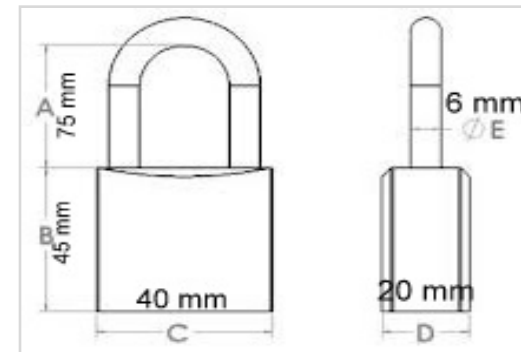

**Ultra Lightweight
Padlock with 75mm
shackle**

LM-ULPP-LS



CYLINDER LOCKOUTS

Instruction for Use:

Adjust the lockout device to suit the cylinder neck, bring the cap to the close position and apply the padlock to secure the cylinder.



Revolutionary new rugged plastic device is used to lockout cylinder tanks, including propane tanks on fork trucks and stand alone propane tanks. Special design allows device to be used in tight spaces.

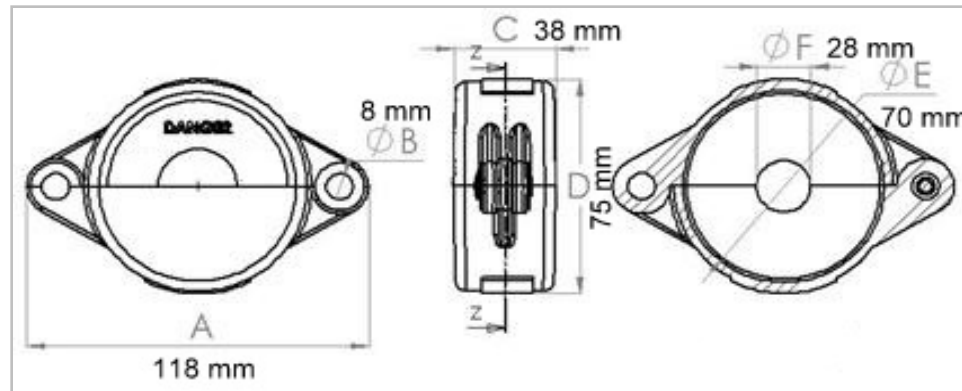

Cylinder Tank Lockout

LM-CTL



Instruction for Use:

Adjust the lockout device to suit the cylinder neck, bring the cap to the close position and apply the padlock to secure the cylinder.



CYLINDER LOCKOUTS

Revolutionary new rugged plastic device is used to lockout cylinder tanks, including propane tanks on fork trucks and stand alone propane tanks. Special design allows device to be used in tight spaces.

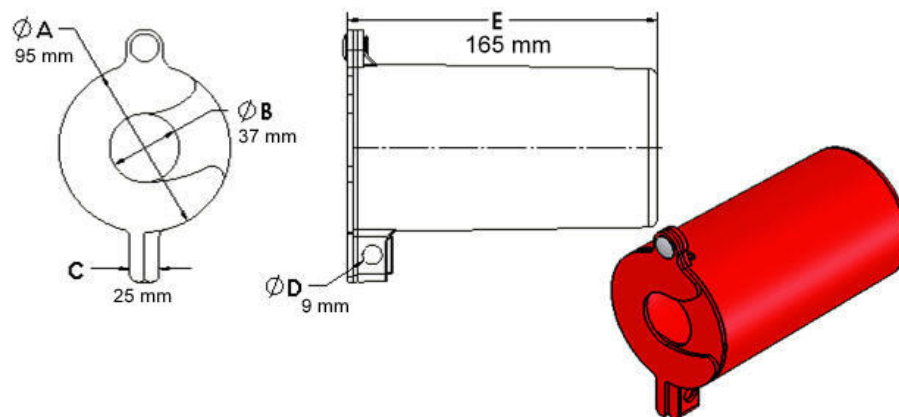

Gas Cylinder Lockout

LM-GCL

VALVE LOCKOUTS



Instruction for Use:

- Fit the two halves of the valve cover over the hand wheel
- Push fit the two halves together
- Lock using a lockout padlock



Versatile, economical lockout adjusts to fit 2.5–16.5cm (1–6 $\frac{1}{2}$ ") diameter valve handles, replacing three conventional gate valve lockouts. Made of durable polypropylene for resistance to extreme temperature changes. Device is compact for easy carrying and storage and features front legend that reads: "DANGER.LOCKED OUT.DO NOT OPERATE."

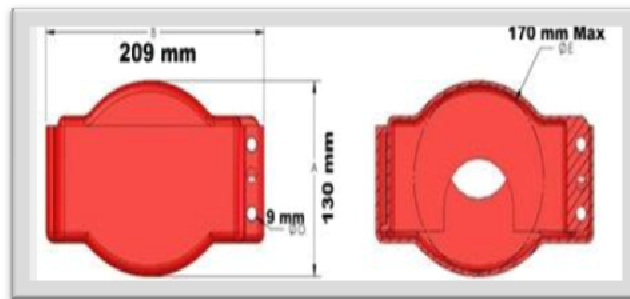

**Adjustable Gate Valve
Lockout**

LM-AGVL

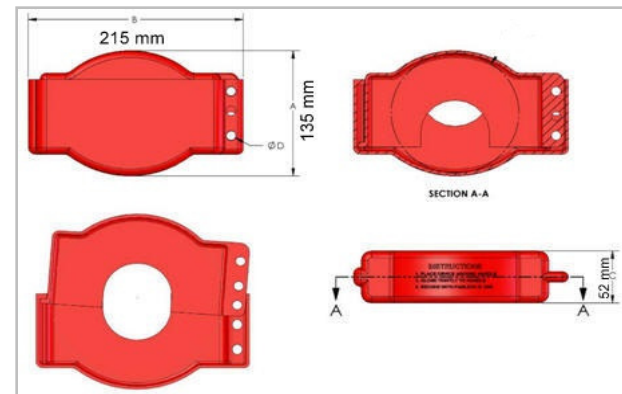



VALVE LOCKOUTS

Gate valve lockouts deny access and cover a valve handle to help you turn a valve off and keep it off. From versatile gate valve lockouts to size specific devices, our products will make sure your valve is secure.

Instruction for Use:

Close the two halves over the valve handle and secure with padlock to complete the lockout.

Gate Valve Lockout of size 1" to 2-1/2"

LM-GVL1

Gate Valve Lockout of size 2-1/2" to 5"

LM-GVL2

Gate Valve Lockout of size 5" to 6-1/2"

LM-GVL3

Gate Valve Lockout of size 6-1/2" to 10"

LM-GVL4

Gate Valve Lockout of size 10" to 13"

LM-GVL5



Models	Inside Diameter A	Inside Height B	Outside Diameter C	Outside Height D	Lock Hole E	Valve Handle Size
LM-GVL1	2.750" 70 mm.	1.250" 32 mm.	3.000" 76 mm.	1.500" 38 mm.	0.312" 8 mm.	1" - 2 1/2"
LM-GVL2	5.000" 130 mm.	1.250" 32 mm.	5.500" 140 mm.	1.750" 44 mm.	0.375" 9.5 mm.	2 1/2" - 5"
LM-GVL3	6.500" 170 mm.	1.500" 38 mm.	7.000" 177 mm.	2.000" 50 mm.	0.375" 9.5 mm.	5" - 6 1/2"
LM-GVL4	10.000" 257 mm.	2.000" 50 mm.	10.500" 267 mm.	2.500" 63 mm.	0.375" 9.5 mm.	6 1/2" - 10"
LM-GVL5	14.000" 355 mm.	2.500" 63 mm.	14.500" 368 mm.	3.000" 73.8 mm.	0.375" 9.5 mm.	10" - 14"

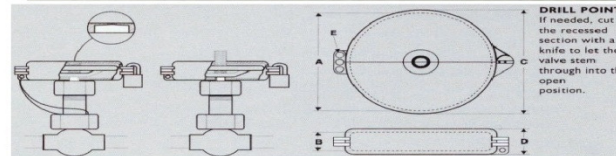

VALVE LOCKOUTS

LM-BVL1



LM-BVL1

LM-BVL2



LM-BVL3

LM-BVL3



LM-BVL2



Ball valve lockout devices will lock out a range of different pipes by securing the valve handle in the OFF position. Our small lockout devices will lock pipes with diameters measuring from ½" to 3". Our large ball valve lockout devices can lock out pipes that range from 2" to 8" in diameter.

Ball Valve Lockout of Size
½" to 1-1/4"

LM-BVL1

Ball Valve Lockout of size 1-
1/2" to 3"

LM-BVL2

Ball Valve Lockout of size 2"
to 8"

LM-BVL3

Instruction for Use:

Turn the valve handle to the off/closed position.

Slip the lockout device onto the valve as far as possible and position it over the angled portion of the valve handle.

Slide the second part onto the valve handle until it fits over the valve handle and insert the lockout padlock into the hole that provides the tightest fit.

When properly installed the valve should not move towards the open end.

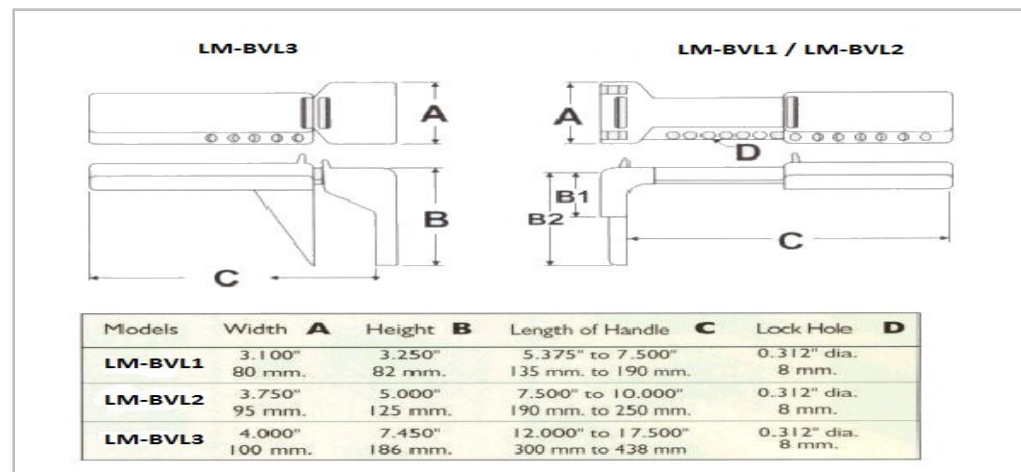

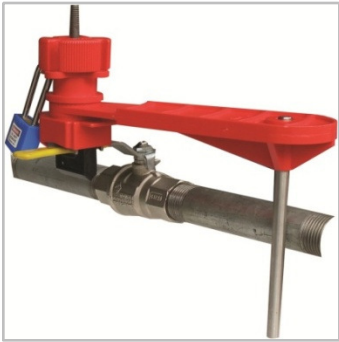

VALVE LOCKOUTS

This valve lockout is constructed from tough nylon and stainless steel to avoid corrosion. It is used for precise Locking & closing/opening of the ball valves of various sizes and makes. Designed to lock out quarter-turn valves of varying sizes and geometric handle dimensions (round, square or flat) up to 1-1/4" thick x 1-5/8" wide and various lengths. Valves can also be locked in the ON or Throttled positions for non lock-out applications.

Instruction for Use:

- Compress the hand wheel knob to open clamp
- Place the valve lockout on the valve handle
- Rotate the ball valve lockout arm against the pipe in the direction of the valve rotation
- Turn the hand wheel clockwise to tighten the clamp against the valve handle
- Place padlock in the locking cleat assembly

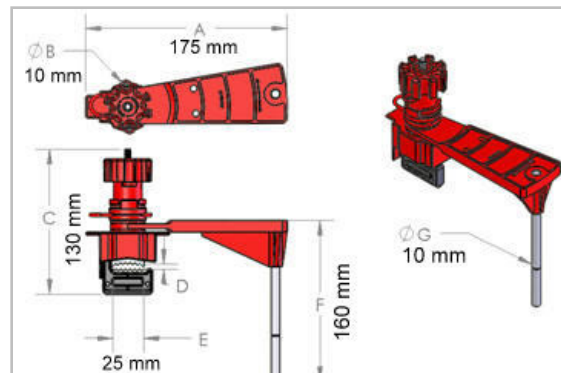

Settable Ball Valve Lockout of size Small

LM-SBVL-S

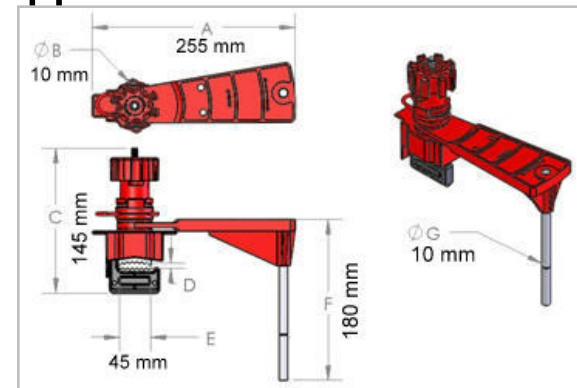

Settable Ball Valve Lockout of size Big

LM-SBVL-B



VALVE LOCKOUTS

Our Universal valve lockouts are effective for all types of standard valves. They can also be used to lock out large levers, T-handles and hard to secure mechanical devices. It is made of industrial grade steel and nylon for extra impact and chemical resistance. Cable attachment offers non-conductive nylon or rustproof sheathed metal cable.

Instruction for Use:

Compress the hand wheel knob to open clamp. Place the valve lockout on the ball valve, gate valve or butterfly valve handle. Rotate the lockout knob clockwise to tighten it until the lockout device fits securely on the valve handle. If required, use the cable provided to secure the valve handle and make sure that it cannot be operated once it is tightened. Place the lockout padlock in the locking cleat assembly and check if the valve has been securely locked out



Universal Valve Lockout

LM-UVL



CIRCUIT BREAKER LOCKOUTS

This large circuit breaker lockout is used to lockout wide range of 3 phase circuit breakers. Made of rugged engineering plastic, it fits on levers up to 3" wide and 0.9" thick.

Instruction for Use:

To install, simply put the circuit breaker handle to the "OFF" position and place the lockout over the handle. Then tighten the set screw by hand, rotate the toggle and apply a lockout padlock. Make sure the switch is completely locked out and cannot be energized until the lockout device is removed.

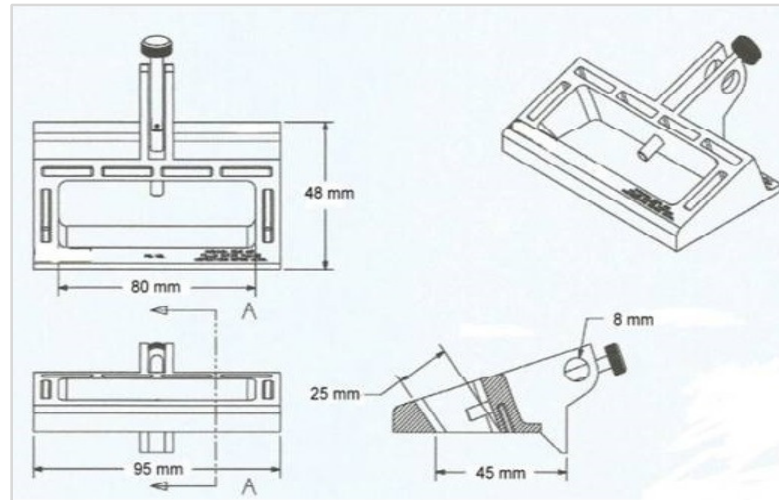

Large Circuit Breaker Lockout- Round

LM-LCBL-R



Large Circuit Breaker Lockout- Toggle Type

LM-LCBL-T



CIRCUIT BREAKER LOCKOUTS

Fuse lockouts is designed to lockout most of the fuses. Once the fuse is locked out it will help prevent un-intended energization of the energysource.

Instruction for Use:

Clamp the lockout device onto the fuse holder using a small screwdriver and the set screw in the device. Place a padlock through the hole to prevent access to the set screw.

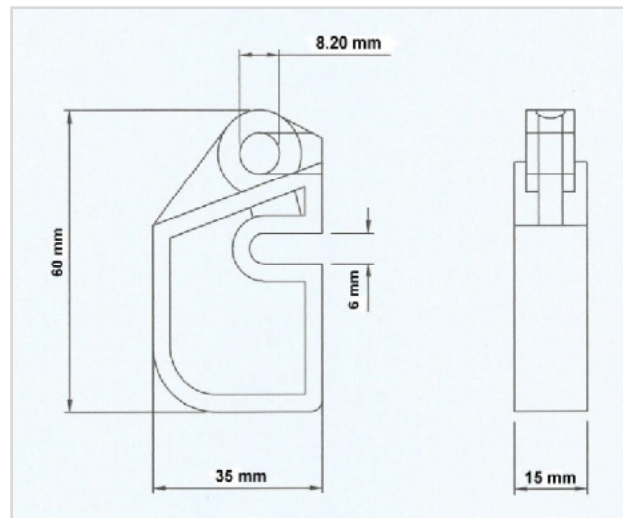

Fuse Lockout

LM-FL



CIRCUIT BREAKER LOCKOUTS

The large circuit breaker lockout is used to lockout wide range of circuit breakers. It is made of rugged plastic and easy to install. This is a must have lockout device for any electrician.

Instruction for Use:

Clamp the lockout device onto the circuit breaker toggle in the OFF position using a small screwdriver and the set screw in the device. Place the padlock through the hole to prevent access to the set screw.

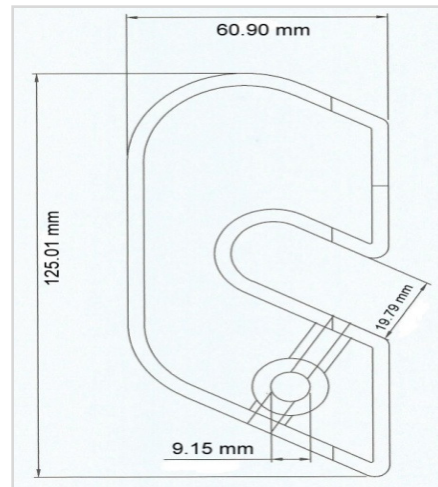

**Large Circuit Breaker
Lockout**

LM-LCL

LM-MCL1



LM-MCL2



LM-MCL3



CIRCUIT BREAKER LOCKOUTS

Circuit breaker lockout can prevent unintended energization of energy source. This MCB lockout is made of durable plastic will lockout most of the miniature circuit breakers.

MCB Lockout 1

LM-MCL1

MCB Lockout 2

LM-MCL2

MCB Lockout 3

LM-MCL3

Instruction for Use:

Clamp the lockout device onto the circuit breaker toggle in the off position using a small screwdriver and the set screw in the device. Place a padlock through the hole to prevent access to the set screw.





CIRCUIT BREAKER LOCKOUTS

Universal circuit breaker lockout is made of durable impact-modified nylon and is compatible with most single & multiple pole breakers. Simply tighten the screw to clamp lockout securely, then insert lock to prevent screw from being loosened.

Instruction for Use:

Clamp the lockout device onto the circuit breaker toggle in the off position using a small screwdriver and the set screw in the device. Place a padlock through the hole to prevent access to the set screw.



**Universal Circuit
Breaker Lockout**

LM-UCBL

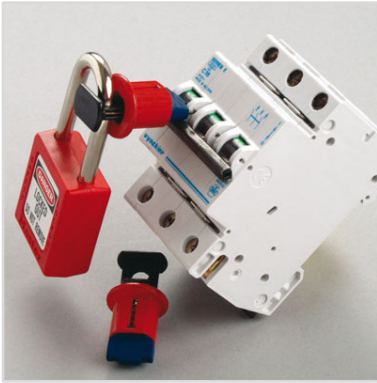

CIRCUIT BREAKER LOCKOUTS

These lockouts do not require any tool for installation. They can be used to Lockout single & multiple pole breakers. Once the lockout is installed on the breaker, apply a padlock to complete the procedure.

Instruction for Use:

Miniature Breaker Lockouts require no tools to install! Standard "Pin" style lockouts can be easily installed with the aid of a push button. Lockouts are available for single and multi-pole breakers. 3 different lockout types are available and are all recommended to be locked with Lotomaster De-Electric, Light Weight, Safety padlock.

Pin-IN MCB Lockout

LM-PIN-IN-CBL

Pin-OUT MCB Lockout

LM-PIN-OUT-CBL

Pin-OUT-WIDE MCB Lockout

LM-PIN-OUT-WIDE-CBL

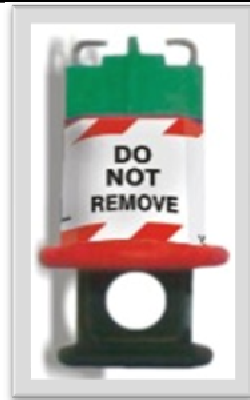



Instruction for Use:

Adjust the lockout device to suit the electrical plug, bring the cap to the close position and apply the padlock to secure the electrical plug. Make sure the plug cannot be removed from the lockout device once the padlock is applied.



ELECTRICAL LOCKOUT DEVICES

The Plug Lockout accommodates high and low voltage electrical plugs upto 3" in diameter and 5 ½" in length. Two sliding top lids can be used individually or together to fit small, medium and large diameter cords upto 1 ¼".

Plug Lockout

LM-PL

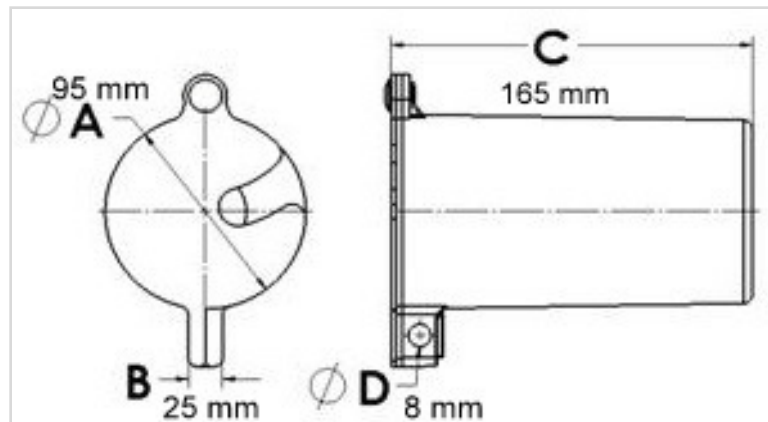



LM-PPL-S



ELECTRICAL LOCKOUT DEVICES

Use when plug will not remain under the exclusive control of the person performing service or maintenance. Device is made of rugged engineering plastic and is designed for 250/500V electrical plugs. It can also be used to lockout air hose nipples.

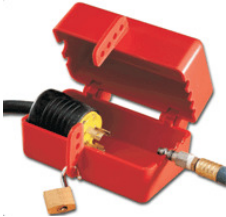

LM-PPL-B

Instruction for Use:

Adjust the lockout device to suit the electrical plug, bring the lockout device to the close position and apply the padlock to secure the electrical plug. Make sure the plug cannot be removed from the lockout device once the padlock is applied.

Pneumatic Plug
Lockout- Small

Pneumatic Plug
Lockout- Big

LM-PPL-S

LM-PPL-B

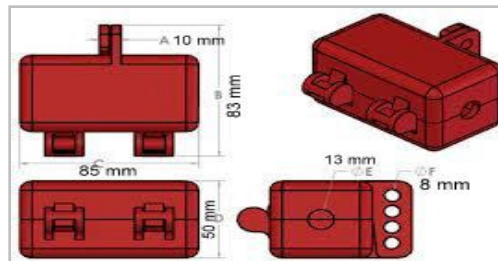

LM-PPL-S

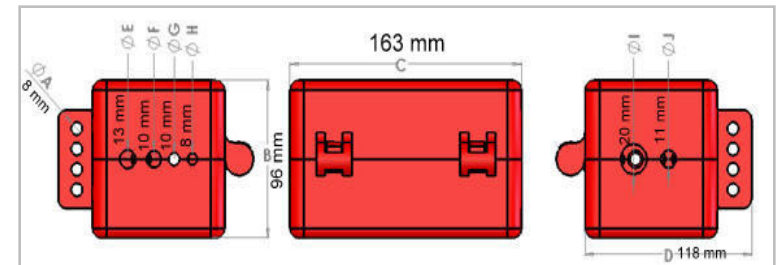

LM-PPL-B



MULTIPURPOSE CABLE LOCKOUTS

The Multipurpose Cable Lockout can be used to lockout a broad range of equipment due to its unique ability to function as a cable lockout device or a stand-alone lockout hasp.

Instruction for Use:

- Pass the cable through the energy isolating device to be blocked.
- Insert the cable through the multipurpose cable lock and pull firmly.
- Compress the locking device to lock the cable in place.
- Insert the lock through one of the holes to secure it in the locked position.

Standard Cable Lockout

Premier Cable Lockout

Universal Cable Lockout

LM-S-MCL

LM-P-MCL

LM-U-MCL



LM-S-MCL

LM-P-MCL

LM-U-MCL

GROUP LOCKOUT BOX



This group Lockout box from Lotomaster is ideal for use in lock off situations where multiple employees and energy sources are involved. All keys can be stored in the lock box before and during isolation. The group lock box is then locked by the supervisor using a single padlock. Once the job is completed the work can be checked by the supervisor before releasing and re-issuing the keys enabling re-start.



LM-GLOB

LM-GLOB-2R



LOCKOUT STATIONS

**Lockout
Station Small**

LM-SMLS

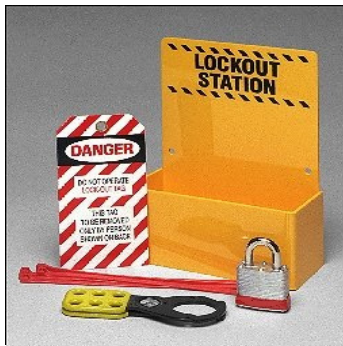

Ideal for small shop floors or multiple locations near machines. Made from tough acrylic and has holes for convenient wall mounting. Used for storing padlocks, hasps and tags.

**Lockout Station
10 locks**

LM-LS-10L



**Lockout Station
6 locks**

LM-LS-6L



**Lockout Station
20 locks**

LM-LS-20L

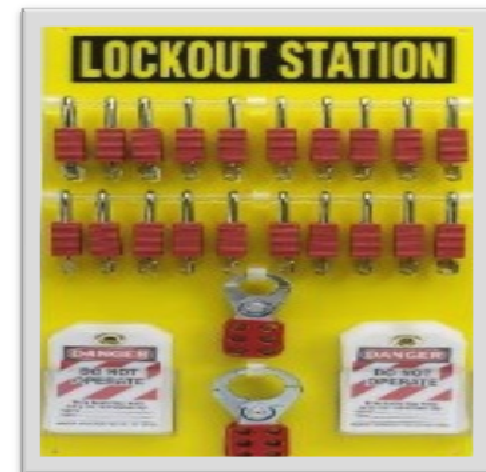

**Lockout Station
36 locks**

LM-LS-36L



SAFETY LOCKOUT TAGS

Tagout devices warn against hazardous conditions if the machine or equipment is energized. Additionally OSHA 1910.333(e) and (f) require that all disconnecting means show the magnitude and shall be legibly marked to indicate the purpose, unless located and arranged so the purpose is evident.

Lotomaster tags are made of flexible plastic which can be attached to all the lockout devices using a padlock or a cable tie.

Standard Tags

Tags with Liner



LM-ST



LM-TWL



- Many More options are available with us.
- Survey / Training / Implementation support facility available
- Customization for all kind of devices will be taken care.

THANK YOU

Paresh Shah
(M) +91 9227221033
ABC Brothers,
Ahmedabad

Uday Shah
(M) +91 9825021033

- info@abcbrothers.in
- paresh@abcbrothers.in



Our Products

- Portables **Honeywell**
- RAE
- BW Technologies

- Fixed Line System **tyco**
- SCOTT
- DETCO INC.
- SIMPTRONICS
- GMI
- OLDHAM

Certified Product

ATEX, CE, cCSAus, SIL2, CEPEL,
INMETRO, PESO, ABS FM,
CNEX, EAC, ANZ, DGMS,
ITRI, CNS

Power In/Output

- 12-28VDC/ 4-20 Ma
- RS485 Modbus RTU
- Relays
- HART

tyco

SCOTT
SAFETY

OLDHAM

DETCO INC.

GMI

Gas Measurement Instruments Ltd

Honeywell

SIMPTRONICS
Fire & Gas

BW
Technologies
by Honeywell

RAE
SYSTEMS



- Technical Support
- Quality Products
- Faster Delivery & Execution
- Customer Satisfaction
- Long Term Support
- Timely Services
- Faster Action
- Customer Care



A.B.C. BROTHERS
INDUSTRIAL & PROJECTS SAFETY SOLUTIONS

"ABC HOUSE" 14/15, Shivam Estate, Nr. Ujala Circle,
B/h. SBI, S. G. Highway, Sarkhej, Ahmedabad-382210. INDIA

Mobile : +91 99099 88162 / 99099 88198 / 7 / 6 / 5
Phone : +91 79 2689 0331 / 4 / +91 79 6510 2323

Email : info@abcbrothers.in / services@abcbrothers.in

GAS detection solution

O₂ H₂S
CO LEL
VOCs NH₃
SO₂
&
more



Solution for

- Industrial Area
- Oil & Gas Sector
- Pharmaceutical
- Chemical Industry
- Cement Industry
- Steel Industry
- Space & Research Organization
- Laboratory & Medical Sector
- Ammonia Refrigeration
- Mining

Services

- Solution for the Gas system
- Fixed line gas detector
- Portable gas detector
- Panel Mounting
- Installation and Commissioning

Breathing Apparatus

- Maintenance of Breathing Apparatus
- Hydro Test of Cylinders
- Refilling of Cylinders
- Services
- Testing



Calibration of GAS System

Our support

- For Portables On Site / off site
- Fixed line Gas System On site only

Certification

- Temporary report on site
- Approved Calibration Report
- Gas Traceability Report
- Proper Method use for cali.
- Take care of Devices
- Systematic Process

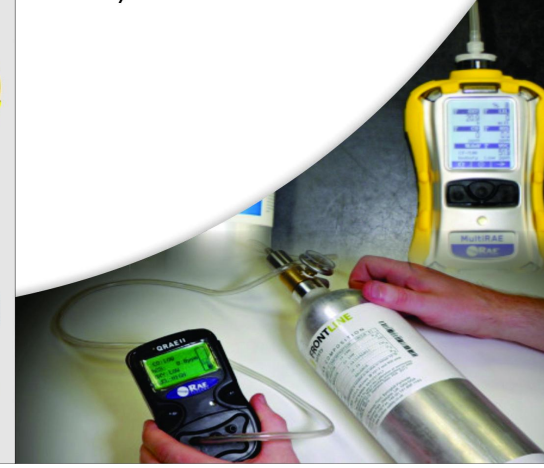

Think Safety... Think A.B.C.

Work at Height - Rescue & Fixed Line System (Vertical & Horizontal)



Gas Detection Solution (Portable & Fixed)



Electrical Protection

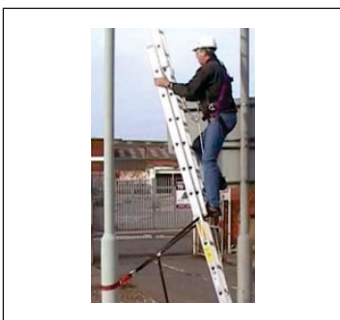
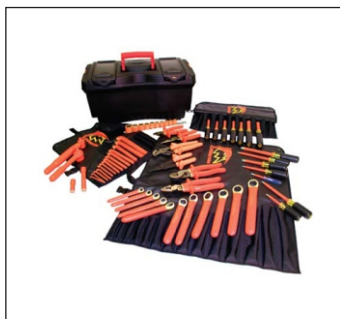
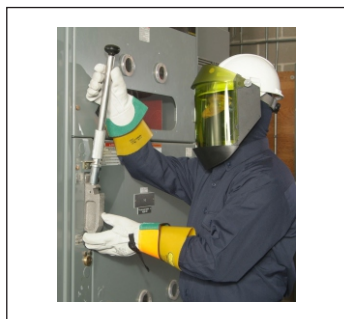

Fire Entry Suit



Fire Entry Suit :
Entire Suit Certified under EN : 1486 Level-III
Weight 7.9 kg only

Fire Fighter Combat Suit



Nomex[®] 3 Layer Suit with Accessories.
EN : 469 : 2005 Level-II

Think Safety... Think A.B.C.

Lock out Tag out Solutions (200+ Options)

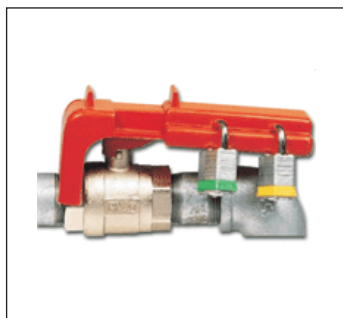
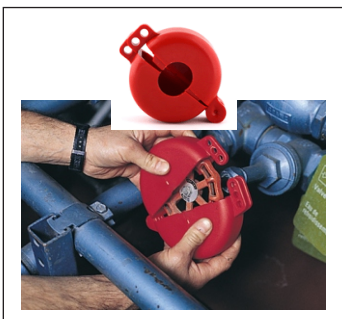
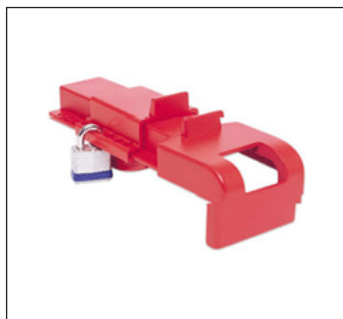

We also undertake PLANT SURVEY & Offer Customization of LOTO Applications

COMPLETE SAFETY SOLUTION UNDER 1 ROOF (400+Options)

HEAD, EYE & EAR PROT.	BODY PROTECTION	RESPIRATORY PROT.	HAND PROTECTION
FALL PROTECTION	FIXED LINE SYSTEM	RAIN WEAR AND SHOES	LOCKOUT TAGOUT
EMERGENCY / RESCUE	FIRE PROTECTION	ROAD/CONST./PROJECT SAFETY	GAS DETECTOR

Authorised Distributors/Channel Partner

A.B.C. BROTHERS INDUSTRIAL & PROJECT SAFETY SOLUTIONS

Off : A/12, Sunspace Complex, Opp. Satyam Status Apt.,
Ramdevnagar Road, Satellite, Ahmedabad-15. Gujarat, INDIA

T : (O) +91-79-6510 2323

F : +91-79-2693 7502

M : +91 99099 88233, 99099 88198 / 7 / 6 / 5

E: info@abcbrothers.in / abcuday@gmail.com

W : www.abcbrothers.in

New Corp. House & Cont. Address (W.E.F. 1-4-2015)
"ABC House" 14-15, Shivam Estate, Near Ujala Circle,
Sarkhej, S. G. Highway, Ahmedabad-382210. INDIA



Follow us on facebook/ABC BROTHERS



EDGE PROTECTION

EDGE PROTECTION

Type : BB

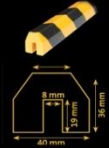

Size :- 40 x 36 mm

Type : G

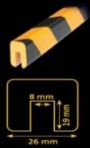

Size :- 26 mm

Type : B



Size :- 40 mm

CORNER PROTECTION

Type : A



Size :- 25 mm

Type : E



Size :- 19 mm

Type : A+



Size :- 35 mm

Type : H



Size :- 35 mm

Type : AA



Size :- 40 x 36 mm

Type : H+



Size :- 48 mm

A.B.C.BROTHERS
INDUSTRIAL & PROJECTS SAFETY SOLUTIONS



SURFACE PROTECTION

Type : C



Size :- 40 x 30 mm

Type : CC



Size :- 40 x 36 mm

Type : D



Size :- 50 x 20 mm

Type : F



Size :- 40 x 11 mm

Type : S



Size :- 75 x 20 mm

PIPING PROTECTION

Type : R30



Size :- 30 mm Inside Radius

Type : R50



Size :- 50 mm Inside Radius

A.B.C.BROTHERS
INDUSTRIAL & PROJECTS SAFETY SOLUTIONS
"ABC HOUSE" 14-15, Shivam Estate, B/H. SBI & Deep Kamal Bajaj
Near Ujala Circle, Sarkhaj, S.G. Highway, Ahmedabad-382210, INDIA
T : (O) +91 - 79 - 26890331 / 4 ALT : +91 - 79 - 6510 2323
E : info@abcbrothers.in / uday@abcbrothers.in
M : +91 - 9825021033, 99099 88233, 99099 88198 / 7 / 6



Made In Germany



A.B.C.BROTHERS
INDUSTRIAL & PROJECTS SAFETY SOLUTIONS

EDGE PROTECTION
Protects against Possible injuries / Damages



Advantages :

- * High visibility Black & Bright Yellow
- * Hazard warning and protection
- * Minimisation of staff absence
- * Reduction of damage-related costs
- * Inside and outside usage
- * Individual lengths up to 50 m
- * Simple and inexpensive to fit
- * Robust and hard-wearing



Protective
Polyurethane
Foil

Core Made of
Polyurethane
Foam

High-Performance
Adhesive

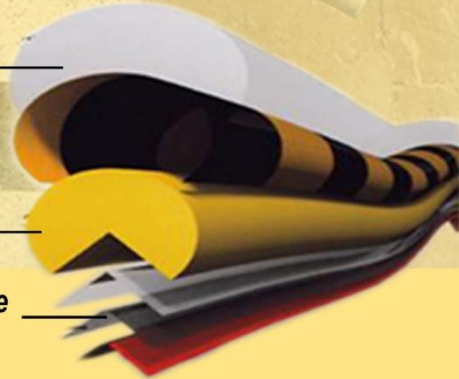

Technical DATA :

- * Adhesive : modified acrylic adhesive resistant to light and ageing on all types except B and BB
- * Bonding strength : 21 N / 25 mm
- * Temperature Resistance : Between -40 °C and +100 °C
- * Fire Test : DIN 4102 B2, UL 94 HB / 10 mm
- * Standard Lengths : 1 m, 5 m, up to 50 lm (Boxed)



A.B.C.BROTHERS
INDUSTRIAL & PROJECTS SAFETY SOLUTIONS

"ABC HOUSE" 14-15, Shivam Estate, B/H. SBI & Deep Kamal Bajaj,
Near Ujala Circle, S.G. Highways Road, Sarkhej, Ahmedabad - 382210. India
T : (O) +91 - 79 - 26890331 / 4 ATL : +91 - 79 - 6510 2323
E : info@abcbrothers.in / support@abcbrothers.in / abccuday@gmail.com
M : +91 - 9825021033, 99099 88233, 99099 88198 / 7 / 6
Website : www.abcbrothers.in



